

Client _____ Quantity _____
Project _____ Position _____

Pass-Through

Model: J110/2M

Cod: J12110200201

Pass-Through refrigerated cabinet for GN2/1 trolleys, 2 doors. Plug-in refrigeration unit, 5 heavy duty climatic class and R290 ecological refrigerant gas. Led lighting, snap handle with lock and key as standard. Temperature range - 2°+8°C with ventilated refrigeration hot gas defrost. 75 mm insulation thickness - HFO with high insulation performance and low environmental impact (CFC, HCFC, HFC free); easily replaceable triple chamber magnetic gasket. One-piece structure, interior/exterior AISI 304 stainless steel, exterior galvanised steel back. Rounded inner corners for easy cleaning. Replaceable refrigerant system FSS - Fast Service System - for quick and easy service. Predisposed for connection to Cosmo remote supervision system and ModBus/RTU Rs485 connection.



Technical data

| | |
|---------------------|---------------------------------|
| Gross capacity: | 838 lt |
| Temperature range: | -2°+8°C |
| Refrigerant unit: | Plug-in |
| Climate class: | 5 |
| Cooling gas: | R290 |
| Defrost: | Hot gas |
| Valve: | Supplied standard with solenoid |
| Dimensions: | 810×880×2115 mm |
| Packing dimensions: | 840×920×2260 mm |
| Gross weight: | 160 Kg |
| Voltage: | 220-240 V - 50 Hz |
| Total rate: | 390 W |
| Absorbed Current: | 1,8 A |
| Cooling capacity: | 713 W* |
| *: | Evap. -10°C Cond. +55°C |

Features

| | |
|------------------------------|--|
| Standard equipment: | LED lighting, lock with key |
| Control: | Electronic, display flush with the panel |
| Doors: | 2 doors, self-closing with a 105° stop, right hinged |
| Door gasket: | Magnetic, triple chamber and easily replaceable |
| Insulation: | 75 mm thickness - CFC/HCFC free |
| Exterior/interior finishing: | Exterior and interior AISI 304 stainless steel. Back in galvanized steel |
| Inner corners: | Rounded for easy cleaning and ensuring maximum hygiene |
| Handle: | Snap-in chrome with integrated lock |
| Cosmo: | Predisposed for Cosmo Hub connection |

Accessories and variants

Alimentazione frequenza 60Hz

Trolley GN2/1 20 trays 598x660x1630 mm

Other special voltage

Cosmo cable connection kit

COSMO - wi-fi control

Cosmo is The Nice Kitchen's exclusive wi-fi technology that allows Coldline, Modular and Nevo appliances to be connected and monitored from a smartphone. The cabinet, connected with Cosmo kit via cable to a Cosmo hub (MODI, VISION, THAW.PRO, Levtronic, QUBI) or with Cosmo wi-fi kit, can be monitored by the CosmoApp and receive alerts in case of abnormal operation.

Technical draw

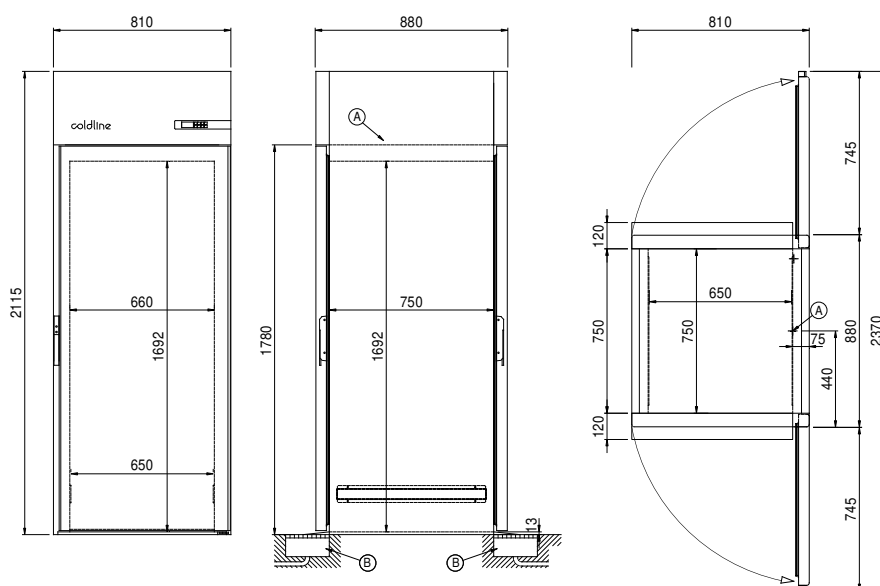

A: Power supply cable outlet

B: Condensation water drain